

# FOLD





## Fold

A playful shape that makes recycling good-looking!  
Fold is made of sheet metal and fits in environments where the requirement for durability is significant, without compromising on design. The lid's unique design is both stylish and obscures the rubbish for neater storage. The modules can be combined with different lids, preferably in groups to create an exciting element in the office, gym, or the local sports arena.

## Facts

Material: 1 mm sheet metal in standard white powder coat  
Available in any colour  
Container volume: 72 l  
Bag size: 125 l  
Gap size: 540 x 143 mm (standard lid), available in other variants  
Protection tray is available as an option  
Adjustable feet are standard  
Labels: Cut-out decal in vinyl plastic and adhesive decal according to Nordic standards





**Fold**  
W5011 Container with lid W5031 lacquered in 9010



## Fold

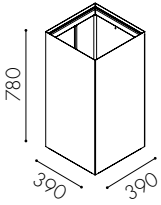

### W5011

Fold container for 125 l bag

## Sheet metal lid

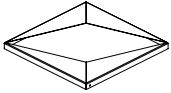

### W5031

P1. (Standard)  
Gap size H: 144

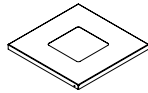

### W5032

P2.  
Gap size W: 170, H: 170

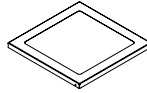

### W5033

P3.  
Gap size W: 300, H: 300

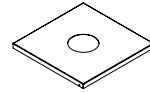

### W5034

P4.  
Gap size Ø 120

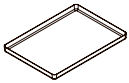

### W5020

Protection tray

Powder coated sheet metal



9010  
Standard



Other colour  
Additional fee